



1/14 Leicester Avenue MOUNT ELIZA VIC

4 3 2

Exquisite design finesse and streams of natural light define the exceptional lifestyle on offer at this brand new townhouse residence, superbly positioned just doors from the vibrant heart of Mt Eliza Village. Delivering the luxury, scale and sophistication of a full family home with the ease of low maintenance living, it is a refined retreat where everyday convenience meets elevated coastal style.

Commanding the front position of an exclusive trio and enjoying its own striking street frontage, the 4 bedroom home showcases a beautiful fusion of architectural influences and premium finishes. Soft curves, layered textures and a subtle coastal aesthetic come together to create a residence of distinctive character and contemporary flair.

**Type** : House

**Price** : \$1,500,000 - \$1,650,000

**View** : <https://www.crowdercre.com.au/8604185>



**Will Crowder**  
9787 7221



**Ben Crowder**  
9787 7221

[For full version visit the website](#)

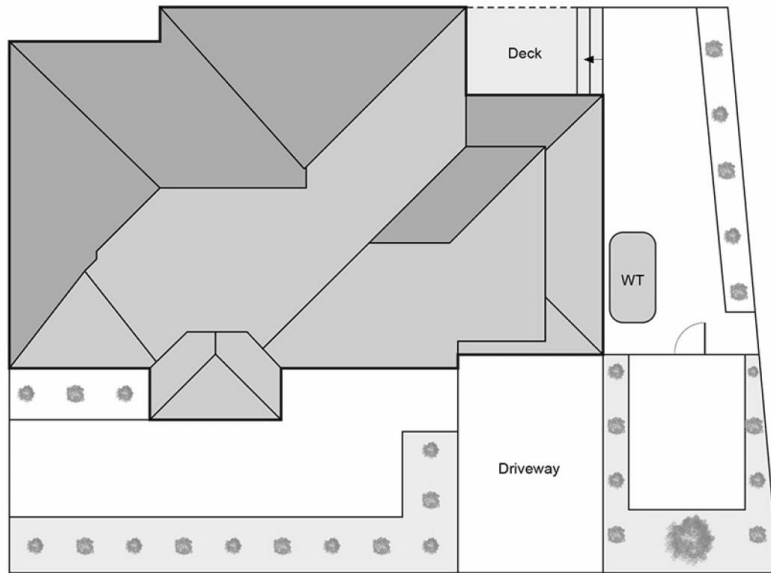

Site Plan

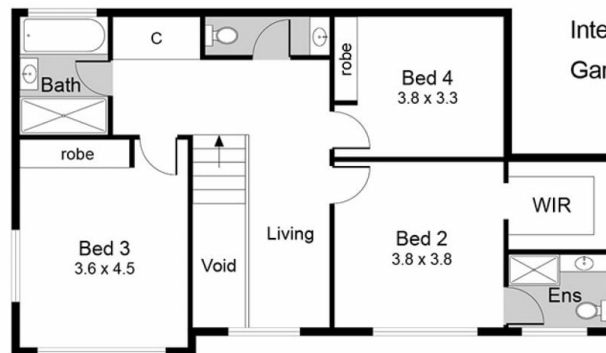

First Floor

Internal Residence 178.0 sqm (approx)  
Garage 22.1 sqm (approx)

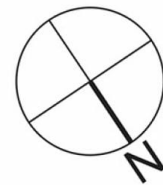

Ground Floor

## 1/14 Leicester Avenue, Mount Eliza

This floorplan is for illustration purposes only and no warranty is given to its accuracy. Purchasers are advised to carry out their own investigations. Produced by realtywriters (03) 5970 2222