



150 Grant Road MOUNT ELIZA VIC

5 🛏 3 🚿 3 🚗

Outstanding architecture that redefines mid-century norms to deliver a home far ahead of its time, this is one of Mt Eliza's most remarkable offerings with nearly an acre of showpiece gardens and a view across the peninsula to Arthurs Seat and the shimmering bay.

Type : House
Price : Contact Agent
Land Size : 3836 sqm
View : <https://www.crowdercre.com.au/8595628>

The original residence of a country estate that once covered this picturesque hinterland, this 55-year-old contemporary homestead heroes the passion and design nous of architect Allan Stillman, while formal geometric parterre hedges and lush, meticulously curated gardens create a setting of rare distinction.



Ben Crowder
9787 7221



Will Crowder
9787 7221

Occupying a prized corner allotment and offering exciting potential to subdivide the rear with its own street frontage

[For full version visit the website](#)



Internal Living Area - 51.1 squares (approx)

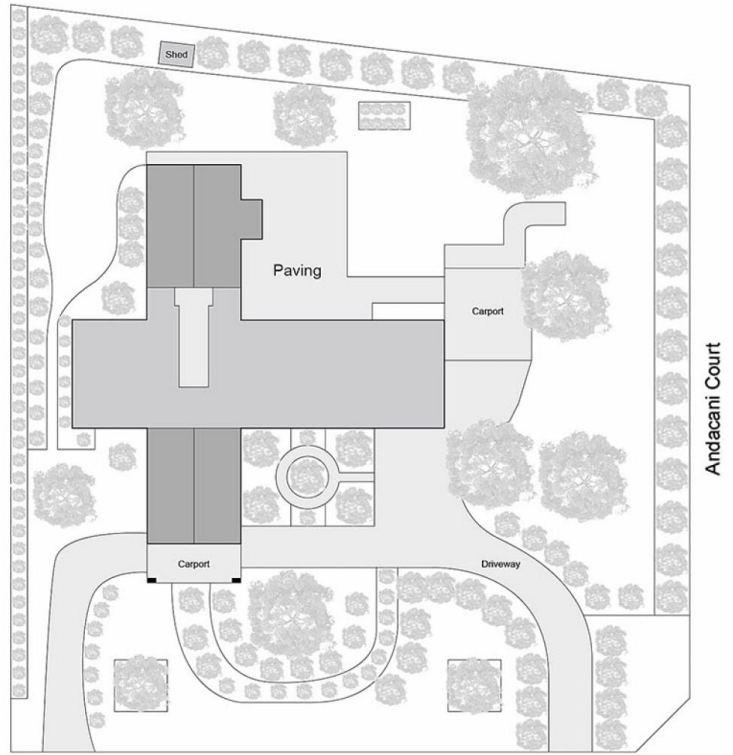

Site Plan

Grant Road

Andacani Court



Floor Plan

150 Grant Road, Mount Eliza

This floorplan is for illustration purposes only and no warranty is given to its accuracy. Purchasers are advised to carry out their own investigations. Produced by realtywriters (03) 5970 2222